



**green  
park  
RESIDENCY**

---

**KHUSHIYON KA NAYA PATA**





# **Green Park Residency**

*The Most Fulfilling Living Experience  
is calling You Home.*



*More than a home,  
It's A Lifestyle!*





# YOUR PLACE FOR THE FUTURE



**'Cause Your Home Should Inspire You Too**  
*HOME AUTOMATION & SMART CONTROLS*



# FLOOR PLAN

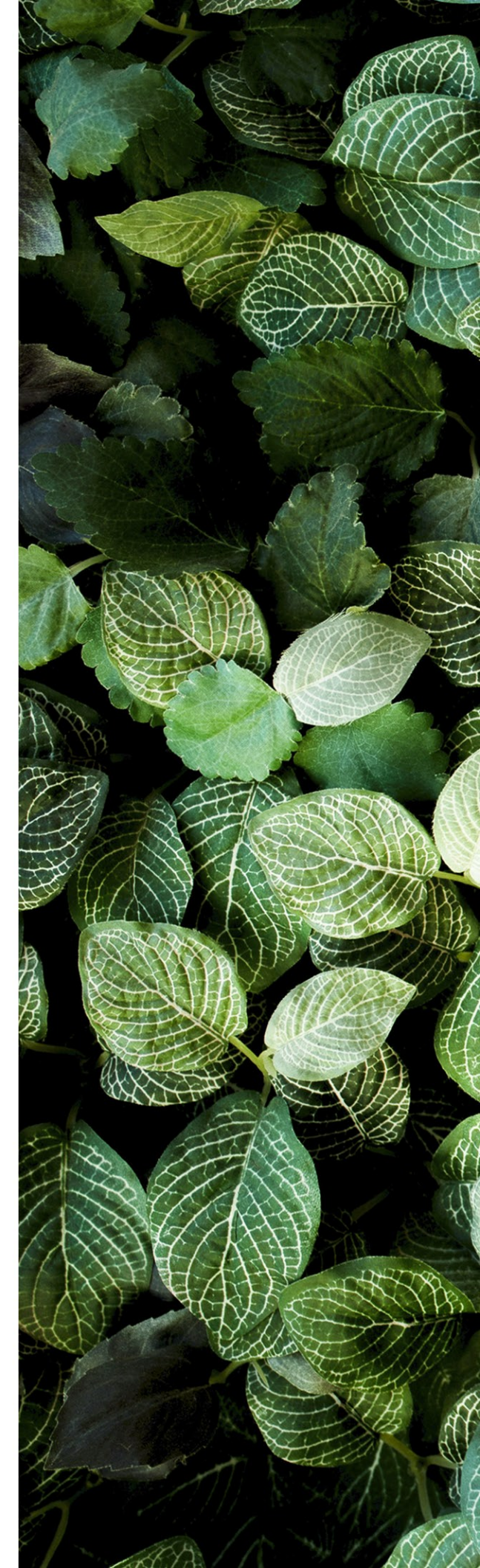
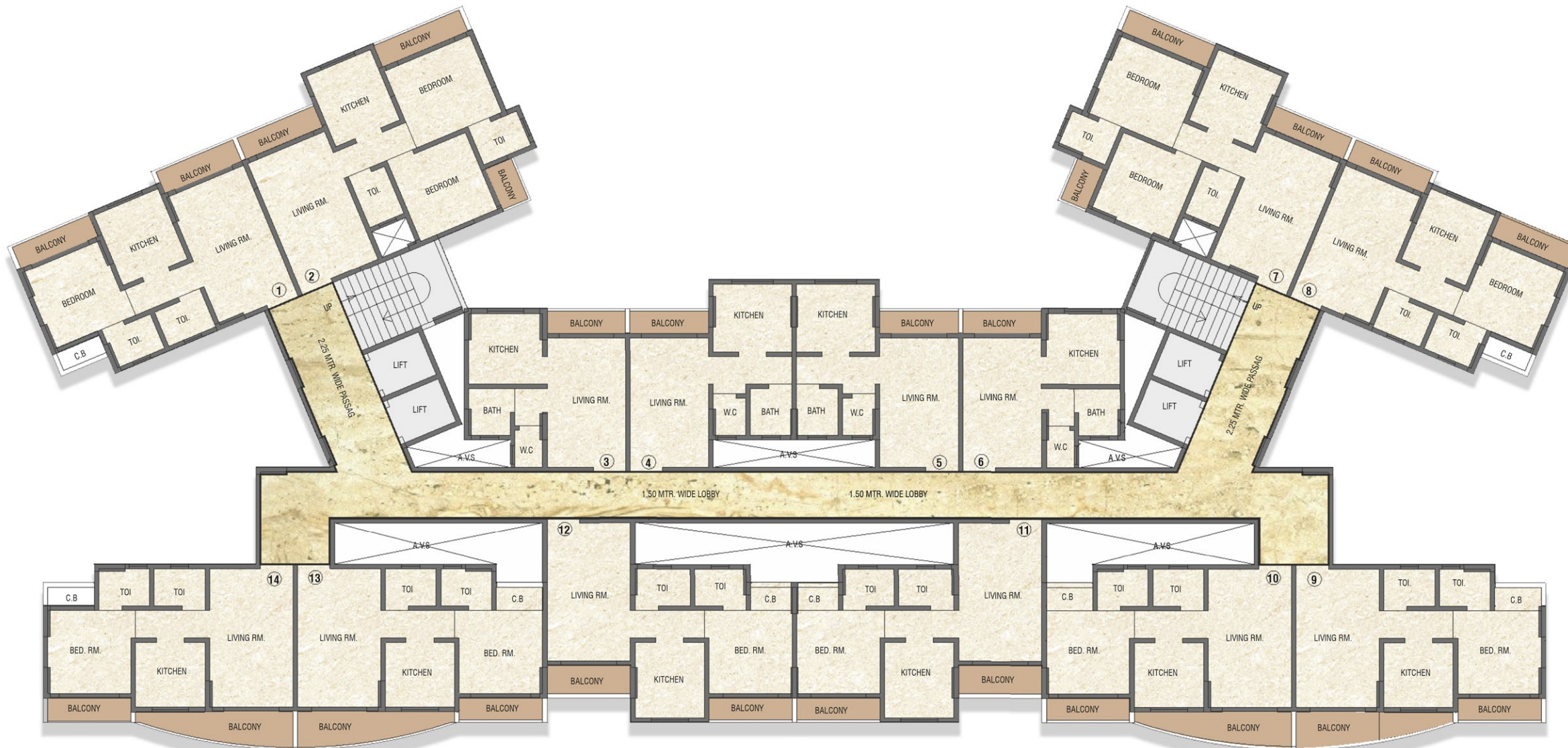



# UNIT PLAN



**1 RK**



**1 BHK**



**2 BHK**



# MAP OUT THE NEXT BIG STORY

## TURN YOUR GPS TO GPR (Green Park Residency)



-  School
-  PVR Cinema
-  Siraj Hospital
-  Great Escape Water
-  Petrol
-  Bus Depot
-  Metro Train
-  Railway station







## **GREEN PARK RESIDENCY**

SITE / OFFICE : Green Park Residenc  
Adjacent To Vishwa Bharati Circle,  
Bhiwandi Wada Road,Kawad,  
Maharashtra - 421302  
Contact - 9607 31 97 77



MAHARERA Registration No.:

**P51700018080**

Approved by MMRDA